

### INCLUDES

- Ratchet cap

### UNIQUE FEATURES

- All-plastic design
- Largest cap offered
- Multiple vent options
- Variety of graphics available
- Complies with California Air Resource Board (CARB) regulations and Environmental Protection Agency (EPA) regulations
- Compatible with Kelch Universal Tether

### REASONS TO CHOOSE

- Ergonomic styling
- Wide diameter for easy fill
- Common thread size
- Well suited for lawn & garden, marine and recreational vehicle, off-highway and construction applications
- Offers audible and tactile feedback with a permanent tether
- Ratchet torque limits potential to over tighten cap



Revised 7/25

Disclaimer: At Kelch, we make quality products. We do not know how you will use our product. You, the customer, are in the best position to know the uses and conditions to which our products will be subjected and to know how our product will perform in your application.

You are responsible for identifying and performing tests necessary to assure that our product is safe and suitable for the application you have chosen. We ask that you hold us harmless from any claims that result from our product being used in an unsafe or unsuitable way.



FOR MORE INFORMATION, CALL OR EMAIL US!  
877.944.5699 • [Products@Kelch.com](mailto:Products@Kelch.com) • [Kelch.com](http://Kelch.com)

©2025 0B7472017



### COMPOSITION

- Engineered thermoplastics
- All-plastic cap designed for use in corrosive environments

### VENTING OPTIONS

- No vent
- Internal vent (0.062 dia. hole)
- Check Valve with inlet and outlet pressures
- One-way vent (in-let vent)

### THREAD SIZE

- 3 1/2" modified buttress thread with 5 threads per inch
- Modified buttress thread allows for expansion and contraction of filler neck

### FILLER NECK SPECIFICATIONS

- Injection molding/blow molding  
- Kelch Print 4066
- Rotational molding  
- Kelch Print 6320

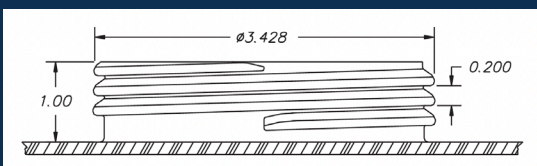

Revised 7/25

Disclaimer: At Kelch, we make quality products. We do not know how you will use our product. You, the customer, are in the best position to know the uses and conditions to which our products will be subjected and to know how our product will perform in your application.

You are responsible for identifying and performing tests necessary to assure that our product is safe and suitable for the application you have chosen. We ask that you hold us harmless from any claims that result from our product being used in an unsafe or unsuitable way.

### MOLDED IN GRAPHICS

Options include:

- Standard mold-in graphics
- Custom molded-in graphics



### TETHER OPTION

- Standard length is 8" (other lengths available upon request)
- Internal and external

### CATCH OPTIONS

- 3 1/2" catch is standard
- 2 1/4" catch is available for applications with smaller filler neck IDs



5211

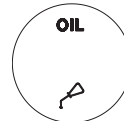

5403



5208

### PAD PRINTING OPTIONS FOR CAPS

- Standard and custom pad printing available

### GASKET OPTIONS

- Nitrile
- FKM



FOR MORE INFORMATION, CALL OR EMAIL US!  
877.944.5699 • [Products@Kelch.com](mailto:Products@Kelch.com) • [Kelch.com](http://Kelch.com)

©2025 0B7472017